

EDI 2" Motor Valve

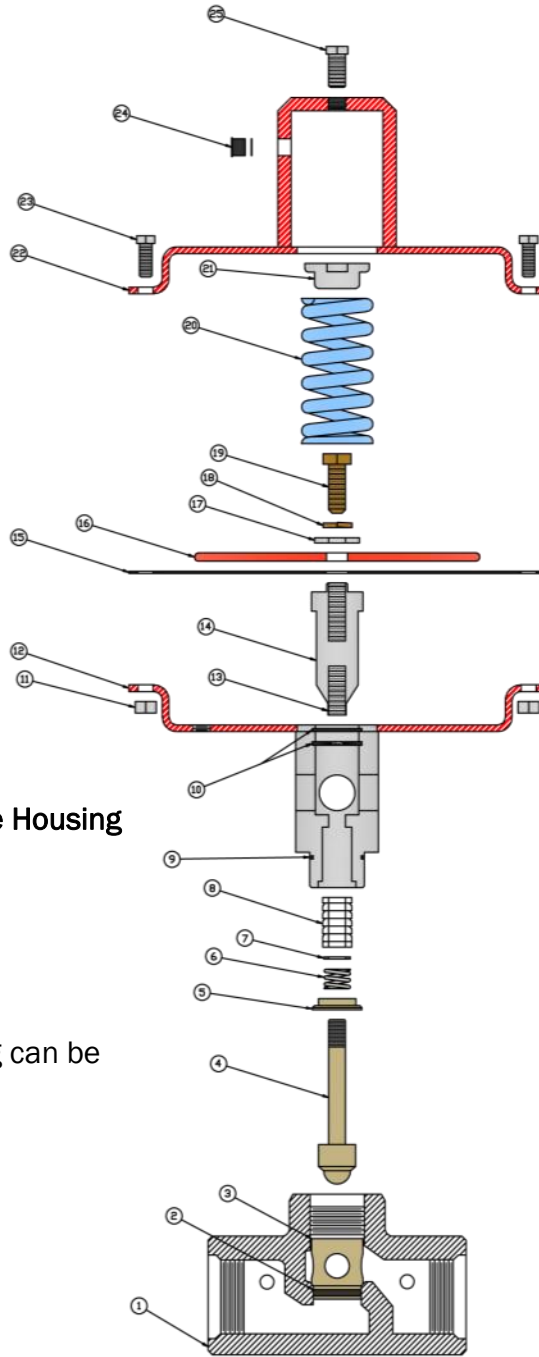

- Working Pressure: 3500 psi
- Supply Pressure: 15-30 psi
- Stainless Steel Stem, Seat and Valve Housing
- Various Port Openings Available
- Body Weight: 16 lbs.
- Top Works Weight: 32 lbs.
- Total Weight: 48 lbs.
- Field Friendly: Stem, Seat, & Packing can be changed in less than 15 minutes

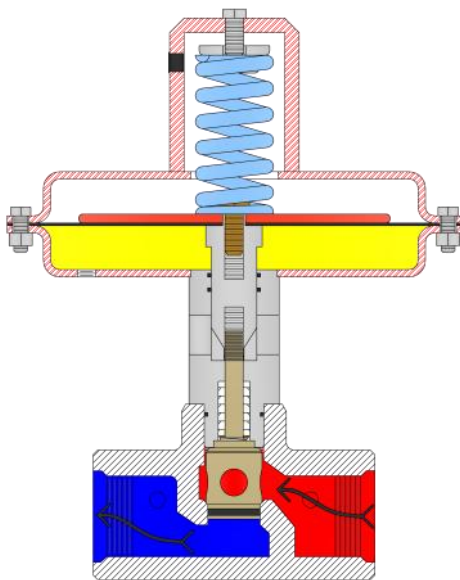

- 23 3/8-11x1" SPRING TENSION BOLT
PART # 3-3/8-11x1
- 24 BREATHER PLUG / SCREEN
PART # HW-446 / HW-445
- 23 DIAPHRAM HOUSING BOLT-ZINC PLATED / 14 REQ'D
PART # 3-3/8-24x1
- 22 UPPER DIAPHRAM HOUSING
PART # E-MV-015
- 21 UPPER SPRING RETAINER
PART # E-MV-004
- 20 DIAPHRAM SPRING
PART # SPRING-017
- 19 1/2-13x1 1/2" DIAPHRAM ASSEMBLY BOLT
PART # 3-1/2-13x1 1/2
- 18 1/2" LOCK WASHER
PART # WASHER-1/2-HD
- 17 LOWER SPRING RETAINER
PART # E-MV-023
- 16 DIAPHRAM PLATE
PART # E-MV-017
- 15 DIAPHRAM
PART # E-MV-009
- 14 VALVE CARRIER
PART # E-MV-008
- 13 O'RING
PART # HW-240
- 12 LOWER DIAPHRAM HOUSING
PART # E-MV-016
- 11 DIAPHRAM HOUSING NUT-ZINC PLATED / 14 REQ'D
PART # NUT-3/8-24-HEX
- 10 218 O'RING / 2 REQ'D
PART # E-MV-013
- 9 220 O'RING
PART # E-MV-014
- 8 TEFLON PACKING
PART # E-MV-010
- 7 PACKING WASHER - BRASS
PART # E-MV-011
- 6 PACKING SPRING
PART # SPRING-016
- 5 PACKING COMPRESSION WASHER
PART # E-MV-006
- 4 STEM
PART # E-MV-005
- 3 SEAT
PART # E-MV-005
- 2 217 O'RING FOR SEAT
PART # E-MV-012
- 1 BODY VALVE
PART # E-MV-018



Electronic Design for Industry
100 Ayers Blvd.
Belpre, OH
(740) 401-4000
<http://www.ediplungerlift.com>

QUALITY & SERVICE
MAKE THE "DIFF"